

MASCHI A MACCHINA - MACHINE TAPS

MASCHI A MACCHINA **HSS-Co-PM**

SCANALATURE DIRITTE - imbocco "C"

Filettatura metrica ISO/DIN 13 - UNI 4535 a passo grosso - **6HX**

Rivestimento AlCrN

Per materiali ad alta resistenza fino a 52 HRC

MACHINE TAPS **HSS-Co-PM**

STRAIGHT FLUTES - Chamfer form "C"

ISO Metric Coarse Thread - UNI 4535 - DIN 13 - **6HX**

AlCrN coated

For high resistance materials until 52 HRC

 HSS-Co-PM



4511.XF0

≤ 52HRC

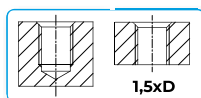

NORMA DI FABBRICA - FIUM NORM

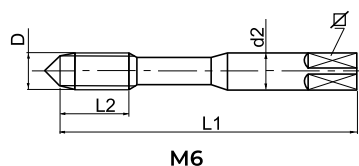

NORMA DI FABBRICA - FIUM NORM

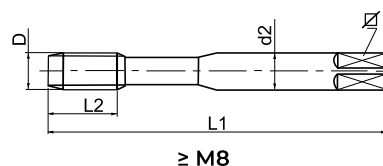

NORMA DI FABBRICA							4511.XF0
D	p	L ₁	L ₂	d ₂	∅		AlCrN
6	1	80	18	6,0	4,9	5,00	43,78
8	1,25	90	25	8,0	6,2	6,80	51,81
10	1,5	100	30	10,0	8,0	8,50	57,42
12	1,75	110	30	12,0	9,0	10,30	79,09

Materiali / Application : H7 / H9