

M

MASCHI A MACCHINA - MACHINE TAPS

MASCHI A MACCHINA **HSS-Co-PM**

SCANALATURE ELICOIDALI - ELICA DESTRA 10° - Imbocco "C"

Filettatura metrica ISO/DIN 13 - UNI 4535 a passo grosso

Rivestimento TiCN per NICKEL e leghe

MACHINE TAPS **HSS-Co-PM**

SPIRAL FLUTES - RIGHT HELIX 10° - Chamfer form "C"

ISO Metric Coarse Thread - UNI 4535 - DIN 13

TiCN coated for NICKEL and alloys



HSS-Co-PM

6HX



4512.XN1

4H



4512.XJN1



CRESTE ARROTONDATE
WITH ROUNDED CREST

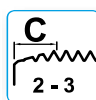
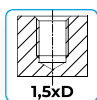
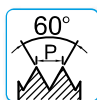

NORMA DI FABBRICA - FIUM NORM

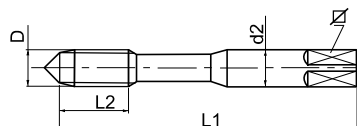

NORMA DI FABBRICA - FIUM NORM

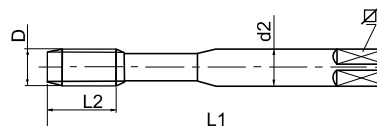

NORMA DI FABBRICA							4512.XN1	4512.XJN1
D	p	L ₁	L ₂	d ₂	∇	⌘	6HX	Filettatura MJ - 4H
3	0,5	56	10	3,5	2,70	2,50	38,39	44,07
4	0,7	63	13	4,5	3,4	3,30	38,39	44,07
5	0,8	70	15	6,0	4,9	4,20	38,39	44,07
6	1	80	18	6,0	4,9	5,00	38,39	44,07
8	1,25	90	25	8,0	6,2	6,80	45,76	53,23
10	1,5	100	30	10,0	8,0	8,50	53,57	59,46

Materiali / Application: P6 / N9 / S5 - S6