

MASCHI A MACCHINA - MACHINE TAPS

MASCHI A MACCHINA **HSSE M35 5%Co**

SCANALATURE ELICOIDALI - ELICA DESTRA 15° - Imbocco "C"

Filettatura ASME B1.1 a passo fine UNF - 2B

MACHINE TAPS **HSSE M35 5%Co**

SPIRAL FLUTES - RIGHT HELIX 15° - Chamfer form "C"

ASME B1.1 Unified Fine Thread UNF- 2B

 HSSE



4574.1



4574.T1

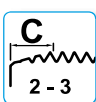
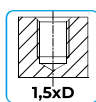
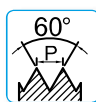

DIN 371 D ≤ 1/4 UNF

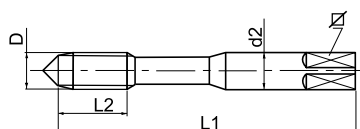

DIN 374 D ≥ 5/16 UNF

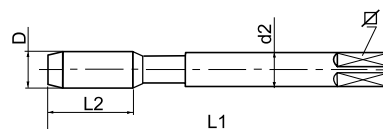

DIN 371 / DIN 374							4574.1	4574.T1
D	filetti x 1" TPI	L ₁	L ₂	d ₂	□		nudi / naked	TIN
n. 6	40	56	11	4,0	3,0	2,95	25,74	35,20
n. 8	36	63	13	4,5	3,4	3,50	25,74	35,20
n. 10	32	70	13	6,0	4,9	4,10	25,74	35,20
n. 12	28	80	16	6,0	4,9	4,60	25,74	35,20
1/4	28	80	16	7,0	5,5	5,50	25,74	35,20
5/16	24	90	18	6,0	4,9	6,90	28,38	39,27
3/8	24	90	20	7,0	5,5	8,50	31,24	43,34
7/16	20	100	20	8,0	6,2	9,90	39,27	55,66
1/2	20	100	22	9,0	7,0	11,50	46,86	63,36
9/16	18	100	22	11,0	9,0	12,90	60,06	82,72
5/8	18	100	25	12,0	9,0	14,50	64,24	88,00
3/4	16	110	25	14,0	11,0	17,50	83,27	117,48
7/8	14	125	25	18,0	14,5	20,40	98,78	143,88
1"	12	140	28	18,0	14,5	23,25	144,10	198,77

Materiali / Application: **nudo / naked:** P1 - P2 - P3 - P4 / N1 - N2 / N6 - N7
TIN: P1 - P2 - P3 - P4 / K3 - K4 / N1 - N2- N3 / N6 - N7