

MASCHI A MACCHINA - MACHINE TAPS

MASCHI A MACCHINA **HSSE M35 5%Co**

SCANALATURE ELICOIDALI - ELICA DESTRA 15° - Imbocco "C"

Filettatura metrica ISO/DIN 13 - UNI 4535 a passo grosso - **Tolleranza 6H + 0,10**

MACHINE TAPS **HSSE M35 5%Co**

SPIRAL FLUTES - RIGHT HELIX 15° - Chamfer form "C"

ISO Metric Coarse Thread - UNI 4535 - DIN 13 - **Tolerance 6H + 0,10**

 HSSE



4812.1



4814.1

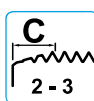
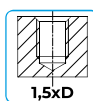
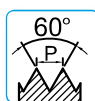

DIN 371 D ≤ 10mm.

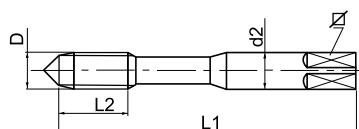

DIN 376 D ≥ 12mm.

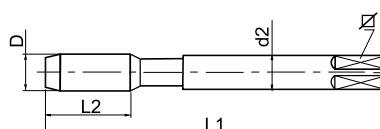

DIN 371 / DIN 376							4812.1	4814.1
D	p	L ₁	L ₂	d ₂	∅		nudi/naked	nudi/naked
3	0,5	56	10	3,5	2,7	2,50	20,79	-
4	0,7	63	13	4,5	3,4	3,30	20,79	-
5	0,8	70	13	6,0	4,9	4,20	20,79	-
6	1	80	16	6,0	4,9	5,00	20,79	-
8	1,25	90	18	8,0	6,2	6,75	23,98	-
10	1,5	100	20	10,0	8,0	8,50	27,39	-
12	1,75	110	25	9,0	7,0	10,25	-	36,85
Rivestimento TiN a richiesta / TiN coating on demand								
Materiali / Application: P1 - P2 - P3 - P4 / N1 - N2 / N6 - N7								

N.B.: ≥ M8 centro femmina / ≥ M8 female center