

MASCHI A MACCHINA - MASCHI A MACCHINA

MASCHI A MACCHINA per DADI HSS M2

SCANALATURE DIRITTE

Filettatura metrica ISO/DIN 13 – UNI 4535 a passo grosso – 6H

Imbocco 18 - 20 filetti



NUT MACHINE TAPS HSS M2

STRAIGHT FLUTES

ISO Metric Coarse Thread – UNI 4535 – DIN 13 – 6H

Chamfer 18 - 20 threads

 HSS



1515

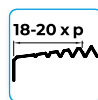
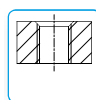
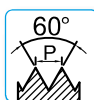

DIN 357

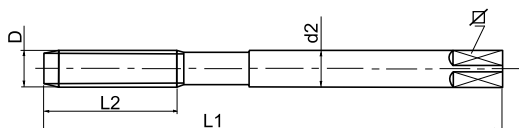

DIN 357							1515
D	p	L ₁	L ₂	d ₂	∠		
3	0,5	70	22	2,2	-	2,50	30,92
4	0,7	90	25	2,8	2,1	3,30	30,47
5	0,8	100	28	3,5	2,7	4,20	30,47
6	1	110	32	4,5	3,4	5,00	30,47
8	1,25	125	40	6,0	4,9	6,75	35,97
10	1,5	140	45	7,0	5,5	8,50	41,58
12	1,75	180	50	9,0	7,0	10,25	60,94
14	2	200	56	11,0	9,0	12,00	83,38
16	2	200	63	12,0	9,0	14,00	89,76
18	2,5	220	63	14,0	11,0	15,50	97,76
20	2,5	250	70	16,0	12,0	17,50	106,52
22	2,5	280	80	18,0	14,5	19,50	124,23
24	3	280	80	18,0	14,5	21,00	142,10

Materiali / Application: P1 - P2 - P3 - P4