

## MASCHI A MACCHINA - MACHINE TAPS

MASCHI A MACCHINA **HSSE M35 5%Co**

SCANALATURE ELICOIDALI - ELICA DESTRA 15° - Imbocco "C"

Filettatura metrica ISO/DIN 13 - UNI 4535 a passo grosso - 6H

MACHINE TAPS **HSSE M35 5%Co**

SPIRAL FLUTES - RIGHT HELIX 15° - Chamfer form "C"

ISO Metric Coarse Thread - UNI 4535 - DIN 13 - 6H

 HSSE



4512.1



4512.V1



4512.T1

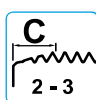
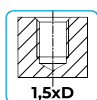
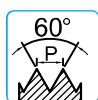

 HSS



1512.1

**ops**

### DIN 371

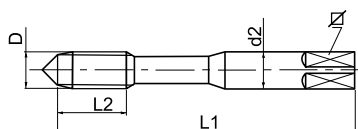

DIN 371							4512.1	4512.V1	4512.T1	1512.1
D	p	L <sub>1</sub>	L <sub>2</sub>	d <sub>2</sub>	∠		nudi/naked	ST	TIN	HSS
2	0,4	45	10	2,8	2,1	1,60	23,21	26,73	*	-
2,5	0,45	50	13	2,8	2,1	2,05	23,21	26,73	*	-
3	0,5	56	10	3,5	2,7	2,50	18,26	25,74	27,50	13,52
3,5	0,6	56	11	4,0	3,0	2,90	21,89	22,11	31,13	-
4	0,7	63	13	4,5	3,4	3,30	18,26	22,11	27,50	13,52
5	0,8	70	13	6,0	4,9	4,20	18,26	22,11	27,50	13,52
6	1	80	16	6,0	4,9	5,00	18,26	22,11	27,50	13,52
7	1	80	16	7,0	5,5	6,00	23,98	28,71	37,73	15,14
8	1,25	90	18	8,0	6,2	6,75	22,88	26,73	34,32	18,12
10	1,5	100	20	10,0	8,0	8,50	24,20	28,71	38,83	-

\*Prezzo a richiesta / Price on demand

Materiali / Application: **nudo / naked:** P1 - P2 - P3 - P4 / N1 - N2 / N6 - N7  
**ST:** P1 - P2 - P3 - P4 / N1 - N2 / N6 - N7  
**TIN:** P1 - P2 - P3 - P4 / K3 - K4 / N1 - N2 - N3 / N6 - N7  
**HSS:** P1 - P2 - P3 - P4

N.B. HSSE M8 e M10 centro femmina / HSSE M8 and M10 female center

## M

## MASCHI A MACCHINA - MACHINE TAPS

MASCHI A MACCHINA **HSSE M35 5%Co**

SCANALATURE ELICOIDALI - ELICA DESTRA 15° - Imbocco "C"

Filettatura metrica ISO/DIN 13 - UNI 4535 a passo grosso - 6H

MACHINE TAPS **HSSE M35 5%Co**

SPIRAL FLUTES - RIGHT HELIX 15° - Chamfer form "C"

ISO Metric Coarse Thread - UNI 4535 - DIN 13 - 6H

 HSSE

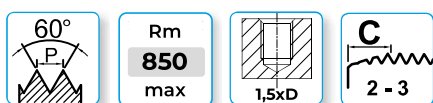

**DIN 376**

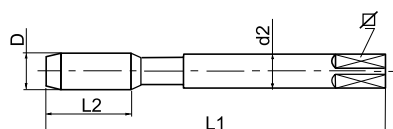

4514.1



4514.V1



4514.T1

 HSS



1514.1 

DIN 376							4514.1	4514.V1	4514.T1	1514.1
D	p	L <sub>1</sub>	L <sub>2</sub>	d <sub>2</sub>	∠		nudi/naked	ST	TIN	HSS
4	0,7	63	13	2,8	2,1	3,30	20,46	24,53	29,81	13,52
5	0,8	70	13	3,5	2,7	4,20	20,46	24,53	29,81	13,52
6	1	80	16	4,5	3,4	5,00	20,46	24,53	29,81	-
8	1,25	90	18	6,0	4,9	6,75	23,32	28,16	34,76	15,14
10	1,5	100	20	7,0	5,5	8,50	38,39	30,91	39,16	18,12
12	1,75	110	25	9,0	7,0	10,25	30,25	34,87	46,75	23,52
14	2	110	28	11,0	9,0	12,00	42,68	48,07	65,23	-
16	2	110	28	12,0	9,0	14,00	46,09	52,80	69,85	-
18	2,5	125	33	14,0	11,0	15,50	69,63	76,89	96,36	-
20	2,5	140	33	16,0	12,0	17,50	73,15	83,71	105,60	-
22	2,5	140	33	18,0	14,5	19,50	84,37	96,03	129,36	-
24	3	160	39	18,0	14,5	21,00	106,59	119,24	161,48	-
27	3	160	39	20,0	16,0	24,00	137,50	152,02	198,44	-
30	3,5	180	46	22,0	18,0	26,50	185,24	202,51	260,26	-
33	3,5	180	46	25,0	20,0	29,50	*	-	-	-
36	4	200	50	28,0	22,0	32,00	*	-	-	-
39	4	200	50	32,0	24,0	35,00	*	-	-	-
42	4,5	200	55	32,0	24,0	37,50	*	-	-	-
45	4,5	220	60	36,0	29,0	40,50	*	-	-	-
48	5	250	65	36,0	29,0	43,00	*	-	-	-
52	5	250	65	40,0	32,0	47,00	*	-	-	-

\*Prezzo a richiesta / Price on demand

Materiali / Application: **nudo / naked:** P1 - P2 - P3 - P4 / N1 - N2 / N6 - N7

**ST :** P1 - P2 - P3 - P4 / N1 - N2 / N6 - N7

**TIN :** P1 - P2 - P3 - P4 / K3 - K4 / N1 - N2 - N3 / N6 - N7

**HSS :** P1 - P2 - P3 - P4